

For personal use only

FULL YEAR REVIEW

TWELVE MONTHS TO 30 JUNE 2017



2017 FINANCIAL YEAR SUMMARY

- Total Software revenue grew by 50% to \$50.2m (2016: \$33.4m). This is the highest Software revenue the Company has ever reported and represents 67% of the Company's total annual revenue of \$74.8m.
- Software License revenue grew 101% to \$23.7m (2016: \$11.8m) and Software annuity revenue grew 17% to \$17.5m (2016: \$15.0m) - a record annual result for both revenue lines.
- Advisory revenue grew for the first time in five years and finished at \$20.4m due to a 7% increase in revenue per Advisory employee.
- Investment in Research and Development rose by 23% to \$12.8m, a \$2.4m increase over FY2016 (\$10.4m).
- Operating EBITDA for FY2017 was \$4.6m, a \$7.8m improvement on FY2016 (\$3.2m loss).
- RPM spent \$0.8m on redundancies to reduce its annual employee cost base by \$3.3m.
- PBT was \$0.8m, a \$10.0m improvement on FY2016 (\$9.2m loss). This is the best PBT result since 2012.
- On 30 June 2017 the Company had \$20.3m in cash and no debt.
- During the year the Company paid out the first year cash consideration for the iSolutions acquisition as well as the guaranteed five year earn-out payments associated with acquiring a copy of the IP rights in the Fewzion product.

2017 OPERATIONAL HIGHLIGHTS

- The first implementations are currently underway for the following products:
 - Open Cut Coal (3) - South Africa, North America, Australia
 - XECUTE - Canadian Oil Sands
 - Underground Metals - Kazakhstan
 - Open Cut Phosphate - Morocco
 - SIMULATE (2) - Global rollouts with 2 major OEMs
- We have just delivered our new AMT mobile application to one of the world's largest mining contractors for final acceptance testing.
- Our first integrated AMT/XERAS Enterprise implementation was completed for a Tier 1 mining major.
- The first implementation of our multi site product optimisation just went live in South Africa.
- The ISA95 Mining Profile was recently expanded to include RPM's integration with the Komatsu suite of products - Modular (FMS) and MineWare (HPGPS).

2017 STRATEGIC HIGHLIGHTS

- At the start of the year RPM acquired iSolutions, the leading global Mining Mobile Equipment asset management software company.
- RPM released four new software products (Open Cut Coal, Stratigraphic Metals, Operations Manager and Underground Metals) as well as provided 46 major functional upgrades to its other software products.
- In December 2016 RPM acquired a copy of the source code and intellectual property rights to the Fewzion Short Internal Control and Work Management software product.
- In May 2017 RPM announced it had entered into a Software License and Distribution Agreement with Alford Mining Systems (AMS) to enable RPM to rebrand, bundle, market and distribute the AMS Stope Optimisation software with RPM's Underground software solutions.
- During June 2017 RPM entered into a Software Integration Agreement with Chasm Consulting Pty Ltd (Chasm) enabling RPM to develop an integration between the industry leading Chasm mine ventilation software Ventsim™ and RPM's Underground software solutions.
- In early August 2017 RPM entered into a Share Purchase Agreement to acquire 100% of the issued share capital of MineOptima, a leading global private company with more than 20 years' experience developing software applications which design the optimal equipment access layouts for Underground mines.

FINANCIAL ANALYSIS



REVENUE BY DIVISION

For personal use only

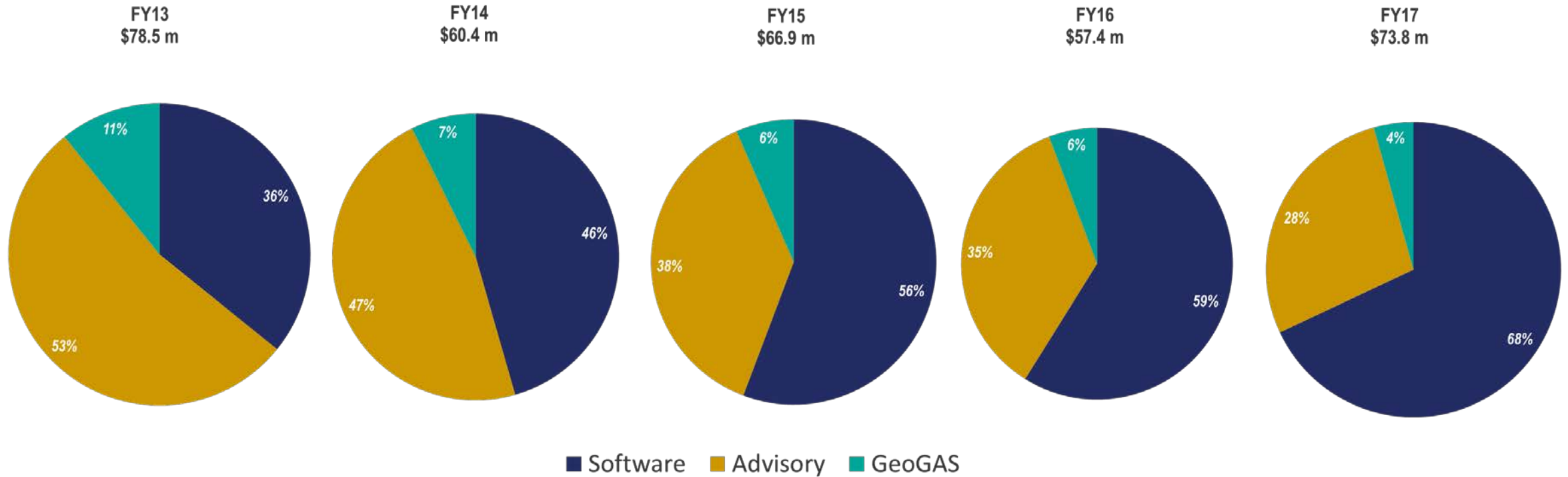

SOFTWARE DIVISION

- The Company achieved strong growth in its Scheduling (111%) and Enterprise (167%) software products.
- Q4 Software sales were \$9.1m which improved the Software Consulting Book of Work and will support healthy annuity (maintenance and support) revenue growth.
- RPM's Business Partner channel in Russia performed strongly in FY17.
- Operating expenses increased due to the acquisition of the iSolutions business.
- The Company expects Software Development costs to increase by 10% in FY18 before starting to drop back more in-line with traditional industry averages.

A\$m	FY17	FY16	\$ Var	% Var
<i>License</i>	23.7	11.8	11.9	101%
<i>Maintenance</i>	17.5	15.0	2.5	17%
<i>Consulting</i>	9.0	6.6	2.4	37%
Software revenue	50.2	33.4	16.8	50%
<i>Direct Costs</i>	(4.0)	(0.9)	(3.1)	344%
<i>Commissions</i>	(1.7)	(0.8)	(0.9)	113%
<i>Operating expenses</i>	(19.4)	(16.8)	(2.6)	15%
Gross Contribution*	25.1	14.9	10.2	68%
Development Expenses	(12.8)	(10.4)	(2.4)	23%
Contribution	12.3	4.5	7.8	173%

* Note this result does not include \$1.6m in one-off bonuses for management

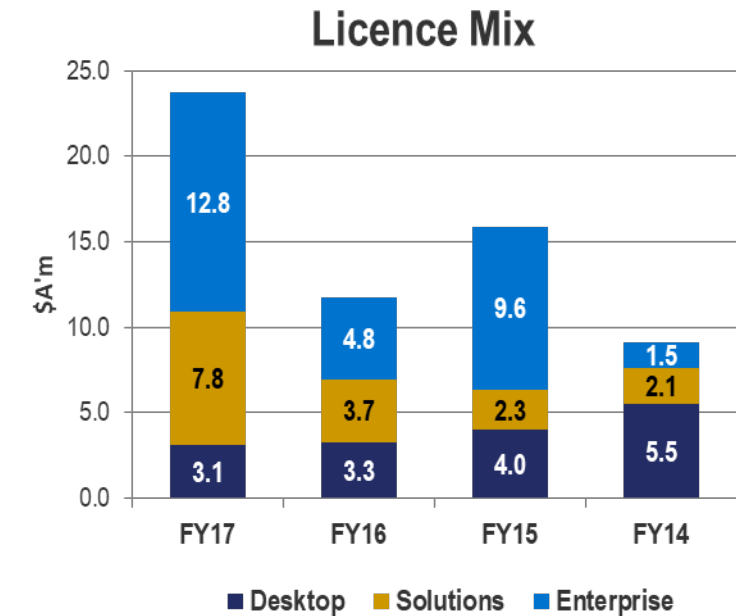
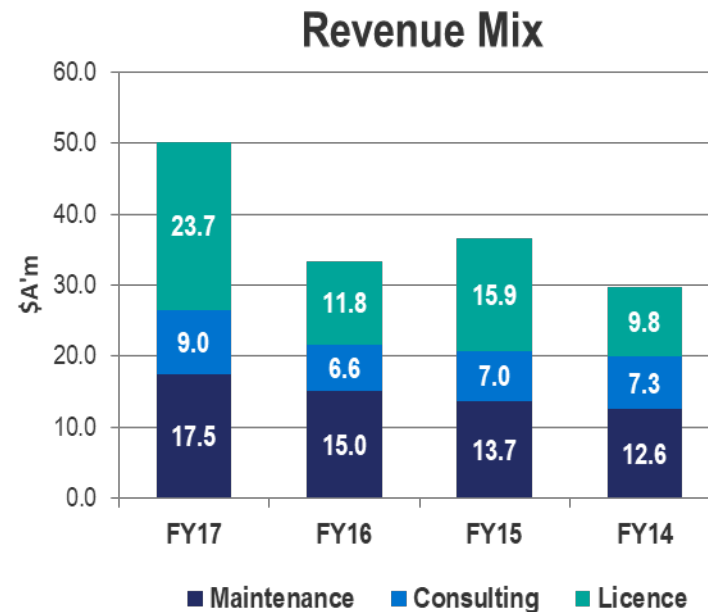

ADVISORY DIVISION

- For the first time in five years Advisory revenue increased year on year.
- The Australian revenue increase of 40% was mainly driven by projects out of North Asia.
- The Advisory division's contribution of \$1.3m was its highest since 2013.
- This was the first time since listing in 2008 that the Advisory division achieved its operating targets.

A\$'m	FY17	FY16	\$ Var	% Var
<i>Australia</i>	8.1	5.8	2.3	40%
<i>Americas</i>	4.4	5.9	(1.5)	(25)%
<i>Asia</i>	7.9	8.6	(0.7)	(8)%
Advisory Revenue	20.4	20.3	0.1	-
Expenses	(19.1)	(19.6)	0.5	(3)%
Contribution*	1.3	0.7	0.6	86%

* Note this result does not include \$0.2m in one-off bonuses for management

Regional Revenue Mix

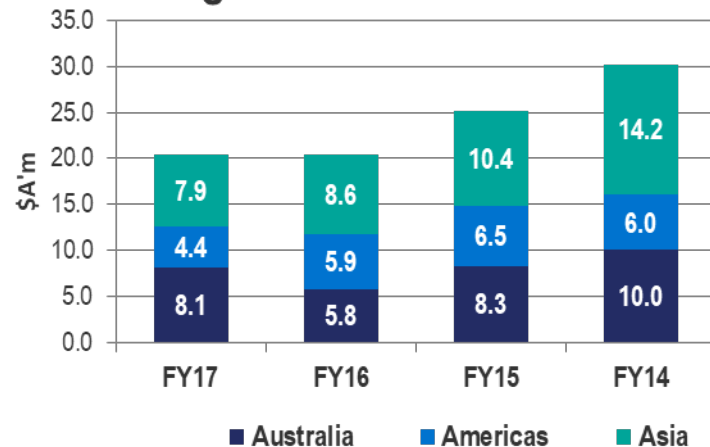

Revenue Per Employee

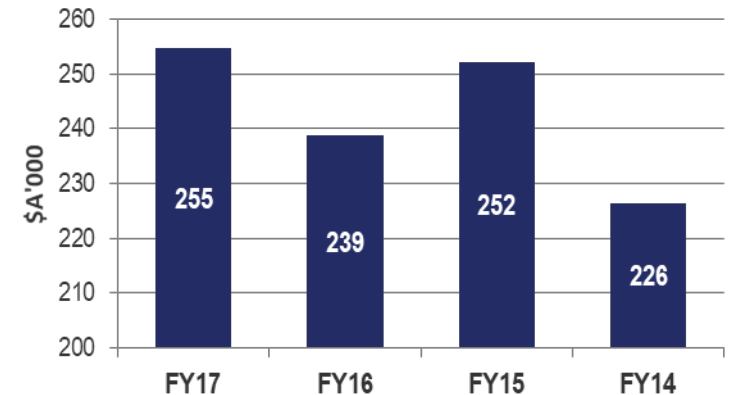

GEOGAS DIVISION

For personal use only

- The H2 contribution from the GeoGAS division increased by 57% over the prior corresponding period.
- Operating expenses reduced by 19% due to a reduction in consulting personnel and a move to more flexible employee arrangements.
- The Company expects to report strong gas consulting revenue growth in FY18.
- The recovery of coal exploration in Australia is accelerating.

A\$'m	FY17	FY16	\$ Var	% Var
Laboratory	2.7	2.6	0.1	4%
Consulting	0.5	0.7	(0.2)	(29)%
GeoGAS revenue	3.2	3.3	(0.1)	(3)%
Operating expenses	(2.1)	(2.6)	0.5	(19)%
Contribution	1.1	0.7	0.4	57%

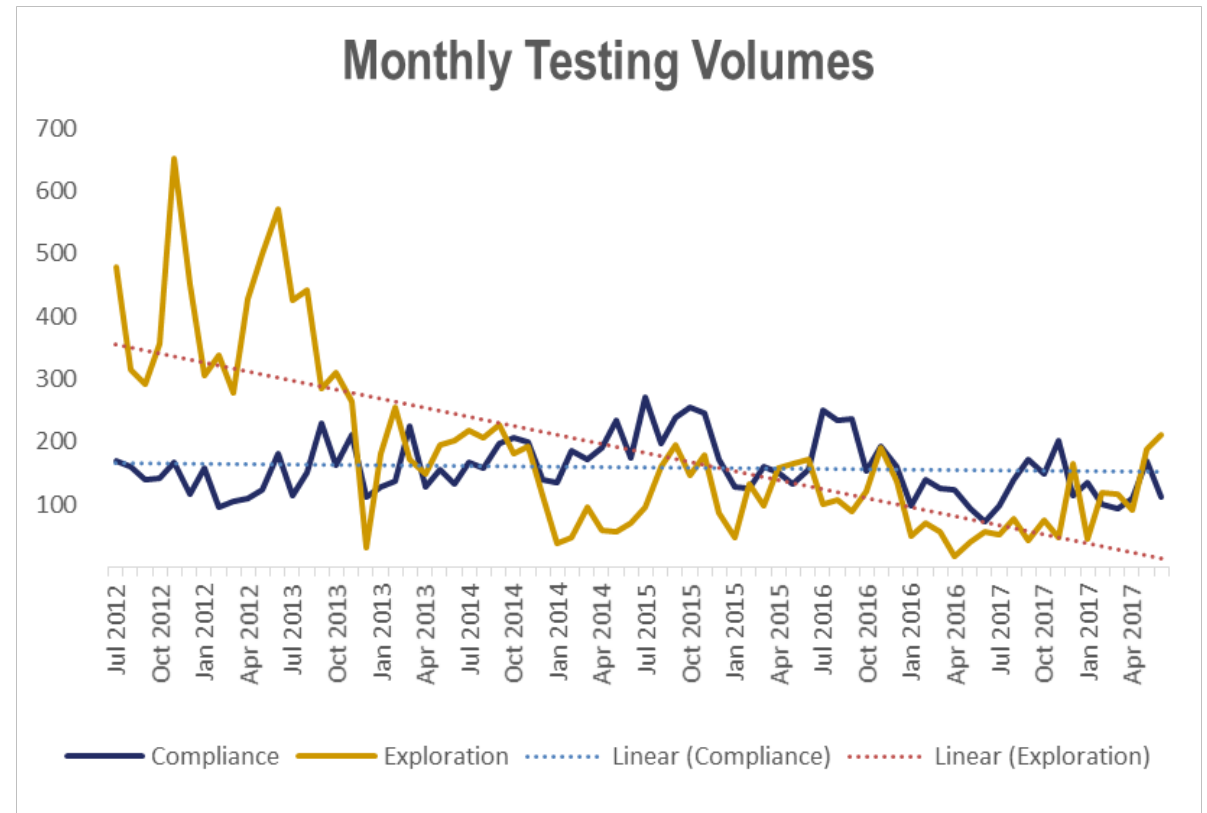

FINANCIAL RESULTS SUMMARY

<i>A\$m</i>	FY17	FY16	\$'var
Revenue	74.8	57.1	17.7
Third party and direct costs	(8.0)	(4.4)	
Commissions	(2.1)	(0.9)	
Bonuses	(3.1)	(0.1)	
Operating expenses	(57.0)	(54.9)	(2.1)
Operating EBITDA	4.6	(3.2)	7.8
Depreciation & amortisation	(2.8)	(1.9)	(0.9)
Net finance costs	0.2	0.3	(0.1)
Operating Profit/(Loss) Before Tax	2.0	(4.8)	6.8
Significant items:			
Impairment of Intangibles	-	(4.0)	4.0
Restructure - staff	(0.8)	(0.4)	(0.4)
Acquisition costs and reorganisation	(0.4)	-	(0.4)
Profit/(Loss) before Tax	0.8	(9.2)	10.0
Income tax expense	(0.8)	-	(0.8)
Net Loss After Tax	-	(9.2)	9.2

BALANCE SHEET

A\$m	FY17	FY16	\$ Var	% Var
Cash	20.3	18.1	2.2	12%
Receivables - Q4 Software Sales	11.7	4.2	7.5	179%
Receivables and WIP	14.9	10.0	4.9	49%
Property, Plant and Equipment	2.1	2.1	-	-
Intangibles	7.5	3.0	4.5	150%
Goodwill	26.5	14.5	12.0	83%
Deferred Tax	8.6	8.7	(0.1)	(1)%
Prepayments, Deposits, etc	2.1	2.1	-	-
Total Assets	93.7	62.7	31.0	49%
Trade Payables	(8.5)	(5.2)	(3.3)	63%
Provisions - Employees	(4.1)	(3.6)	(0.5)	14%
Provisions - Onerous Leases & Make Good	(1.0)	(1.3)	0.3	(23)%
Unearned Income	(11.9)	(8.4)	(3.5)	42%
Earnout payable	(5.8)	-	(5.8)	-
Lease Straightlining, etc	(1.2)	(0.6)	(0.6)	100%
Total Liabilities	(32.5)	(19.1)	(13.4)	70%
Share Capital	85.2	67.0	18.2	27%
Reserves and Retained Earnings	(24.0)	(23.4)	(0.6)	3%
Total Equity	61.2	43.6	17.6	40%

CASH FLOW

\$'m	FY17	2H17	1H17	Change 2H to 1H
Net Cash Beginning of Period	18.1	19.4	18.1	
Cash from Operations	(1.5)	3.7	(5.2)	8.9
Payments for:				
Restructure Costs - Staff	(0.8)	(0.2)	(0.6)	0.4
Restructure Costs - Premises	(0.4)	(0.2)	(0.2)	-
Aquisition Costs	(0.4)	-	(0.4)	0.4
	(1.6)	(0.4)	(1.2)	0.8
Payments for:				
Property Plant & Equipment	(0.6)	(0.4)	(0.2)	(0.2)
Software Acquisitions	(8.2)	(1.5)	(6.7)	5.2
	(8.8)	(1.9)	(6.9)	5.0
Proceeds from:				
Capital Raising	14.4	-	14.4	(14.4)
Net Increase in Cash	2.5	1.4	1.1	
FX Restatement	(0.3)	(0.5)	0.2	
Net Cash End of Period	20.3	20.3	19.4	

For personal use only

For personal use only

SOFTWARE PROGRESS UPDATE



STANDARDISE, SIMPLIFY & INTEGRATE

Deliver a complete **Commercial off the Shelf (COTS) Enterprise planning platform** built on open industry standards.

Release a suite of **simplified, standardised and integrated scheduling solutions** for different commodities and mining methods built on the same product architecture.

Provide software solutions that **deliver a step change** in mine planning, execution and value chain optimisation through **investments in innovation**.



NEW SOFTWARE RELEASED

SINCE 1 JULY 2016 TO DATE

For personal use only

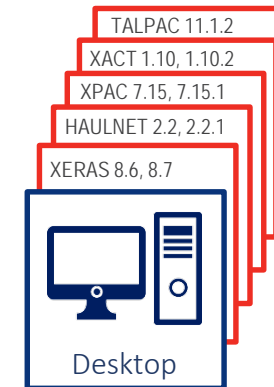
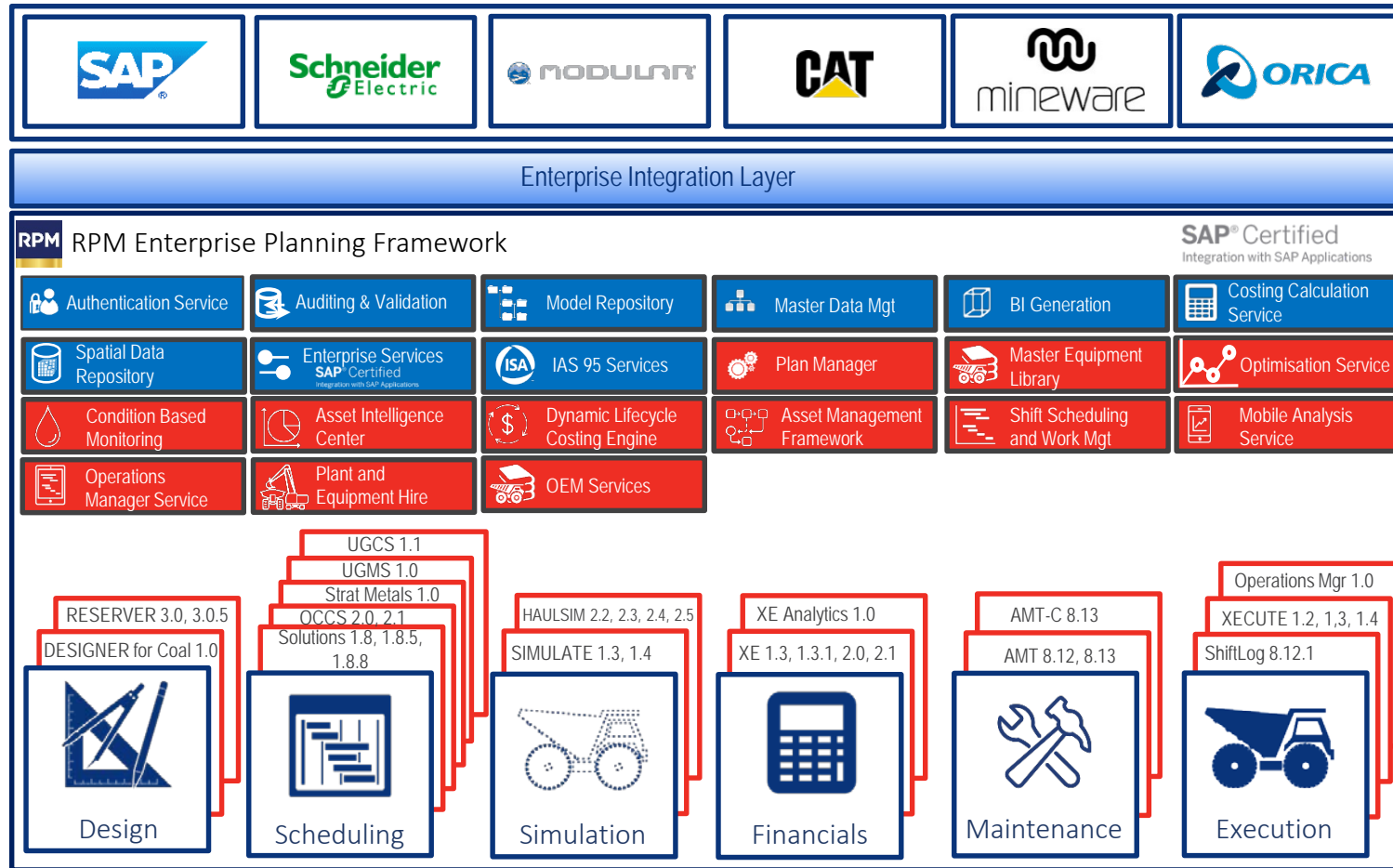

NEW PRODUCT ADOPTION - FY2017

Enterprise Planning Framework









































































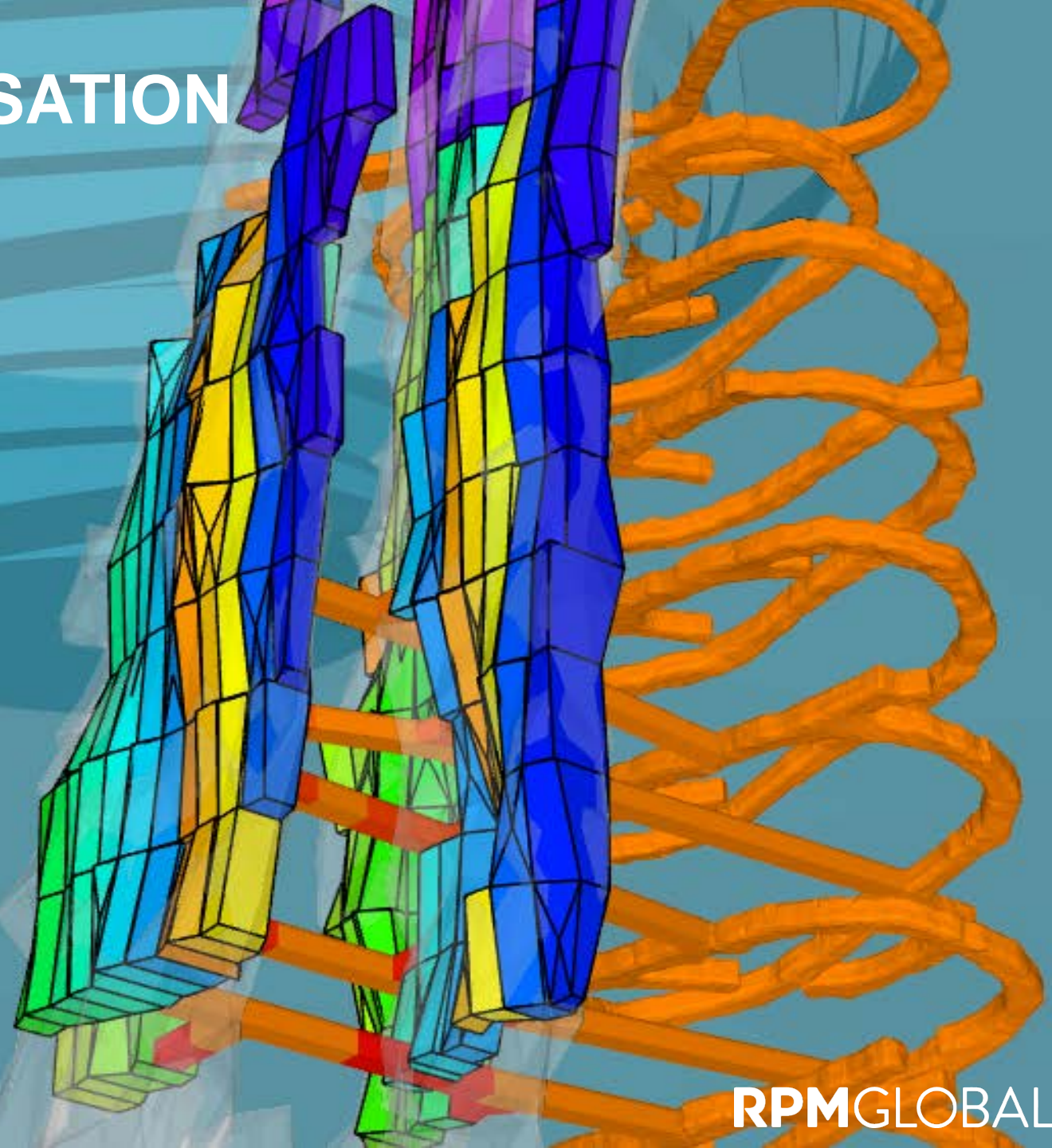

MINE STOPE OPTIMISATION

For personal use only

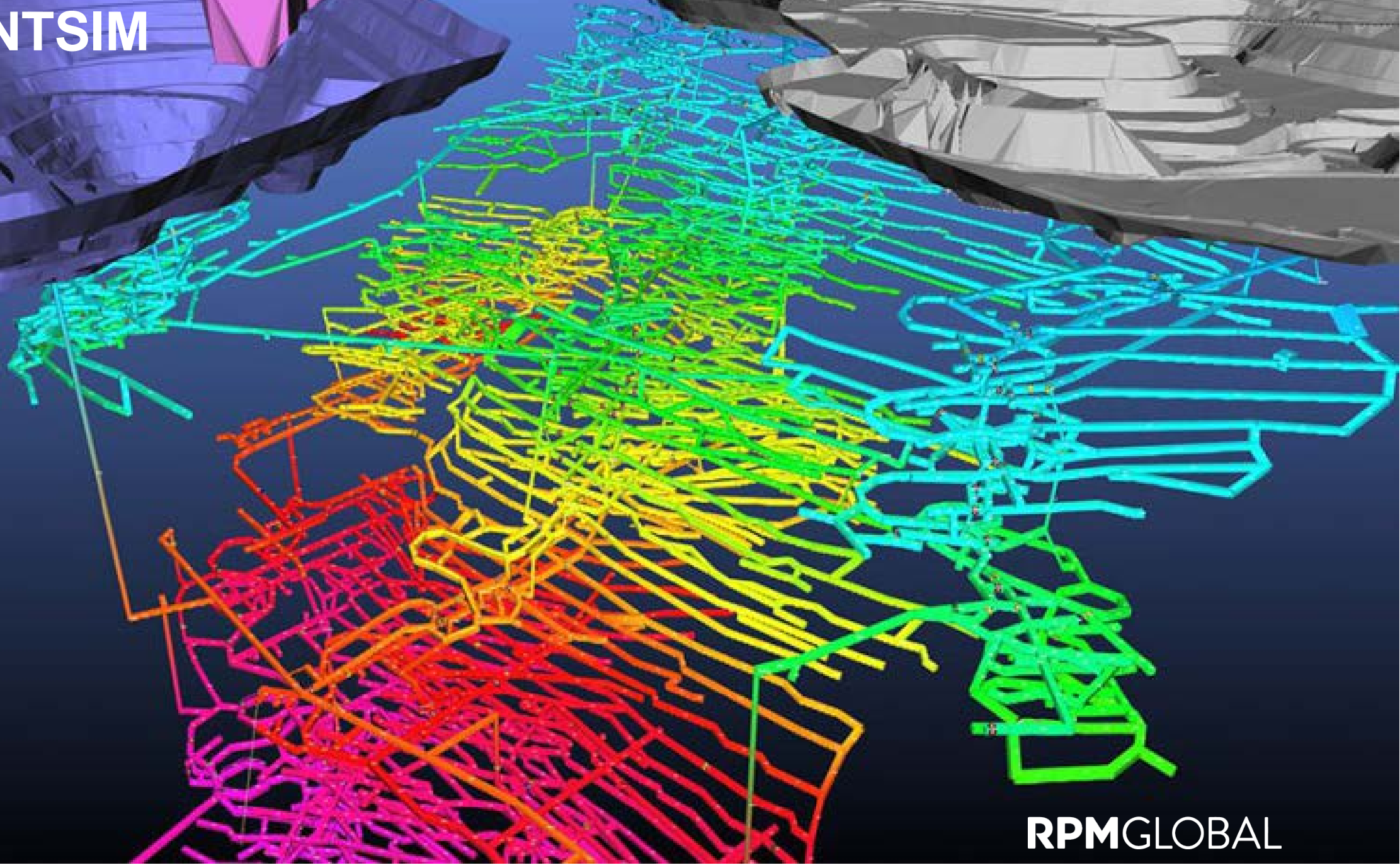

VENTSIM

For personal use only



MINEOPTIMA

For personal use only

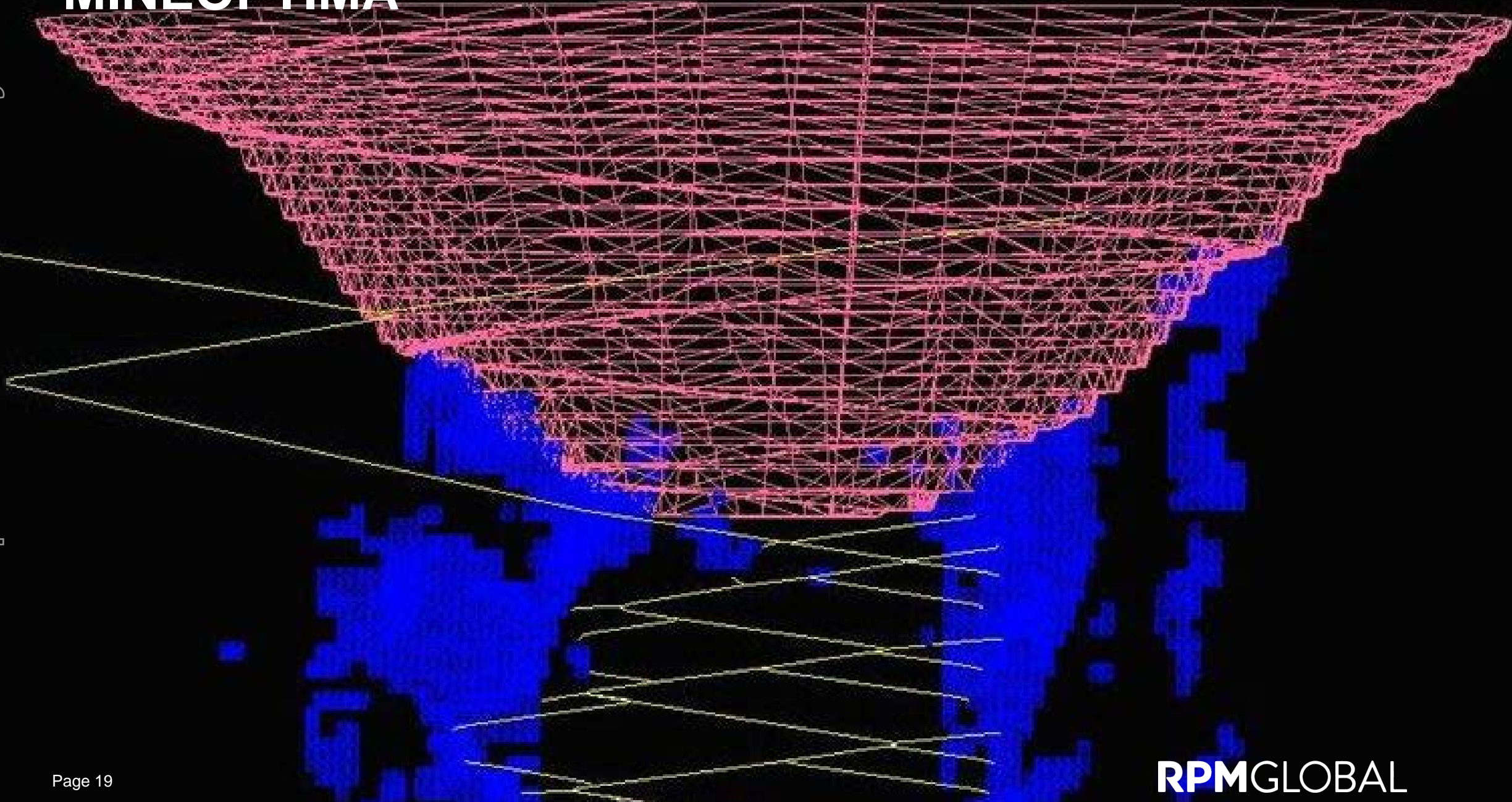

MINEOPTIMA

For personal use only

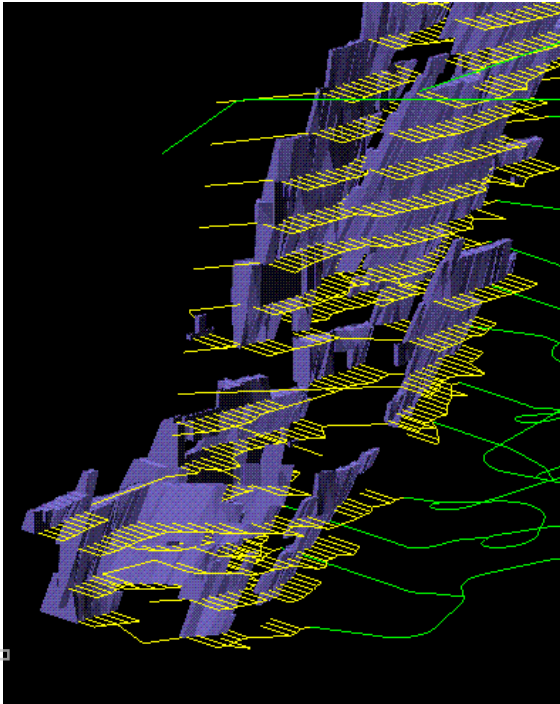

PUNO
Underground Network Optimiser

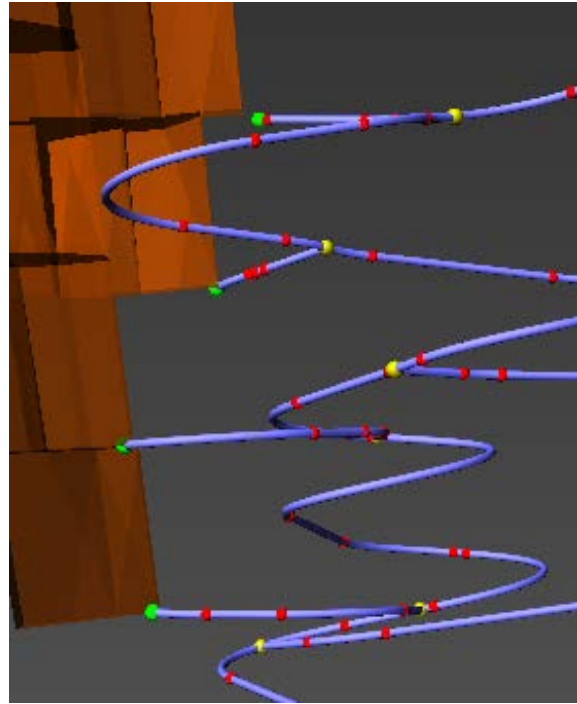

DOT
Decline Optimisation Tool

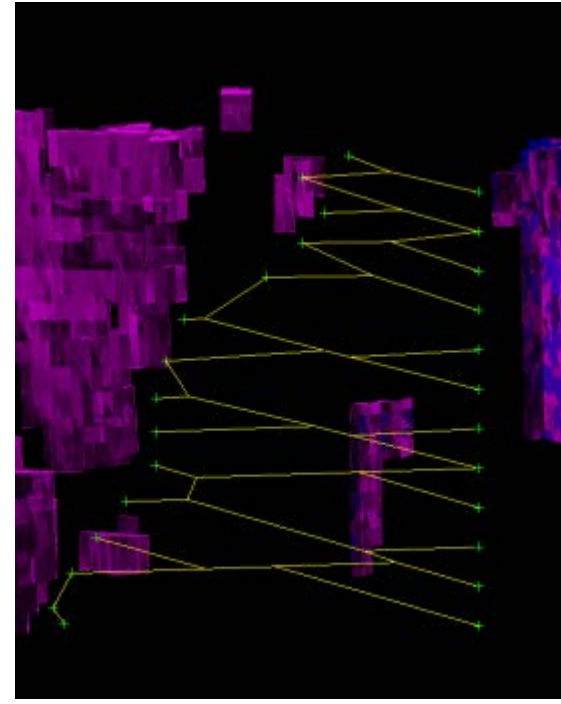

LUNA
*Large Scale Underground
Network Optimiser*

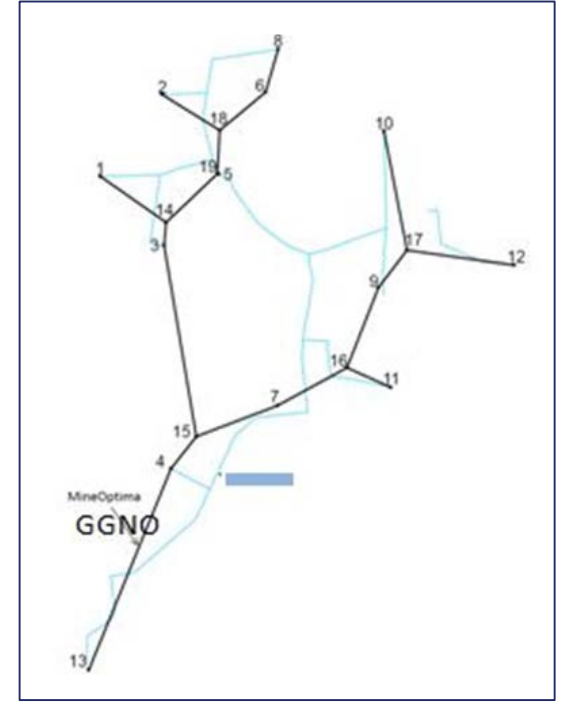

GGNO
*Gas Gathering Network
Optimiser*

MINING COMPANIES BY COMMODITY

For personal use only

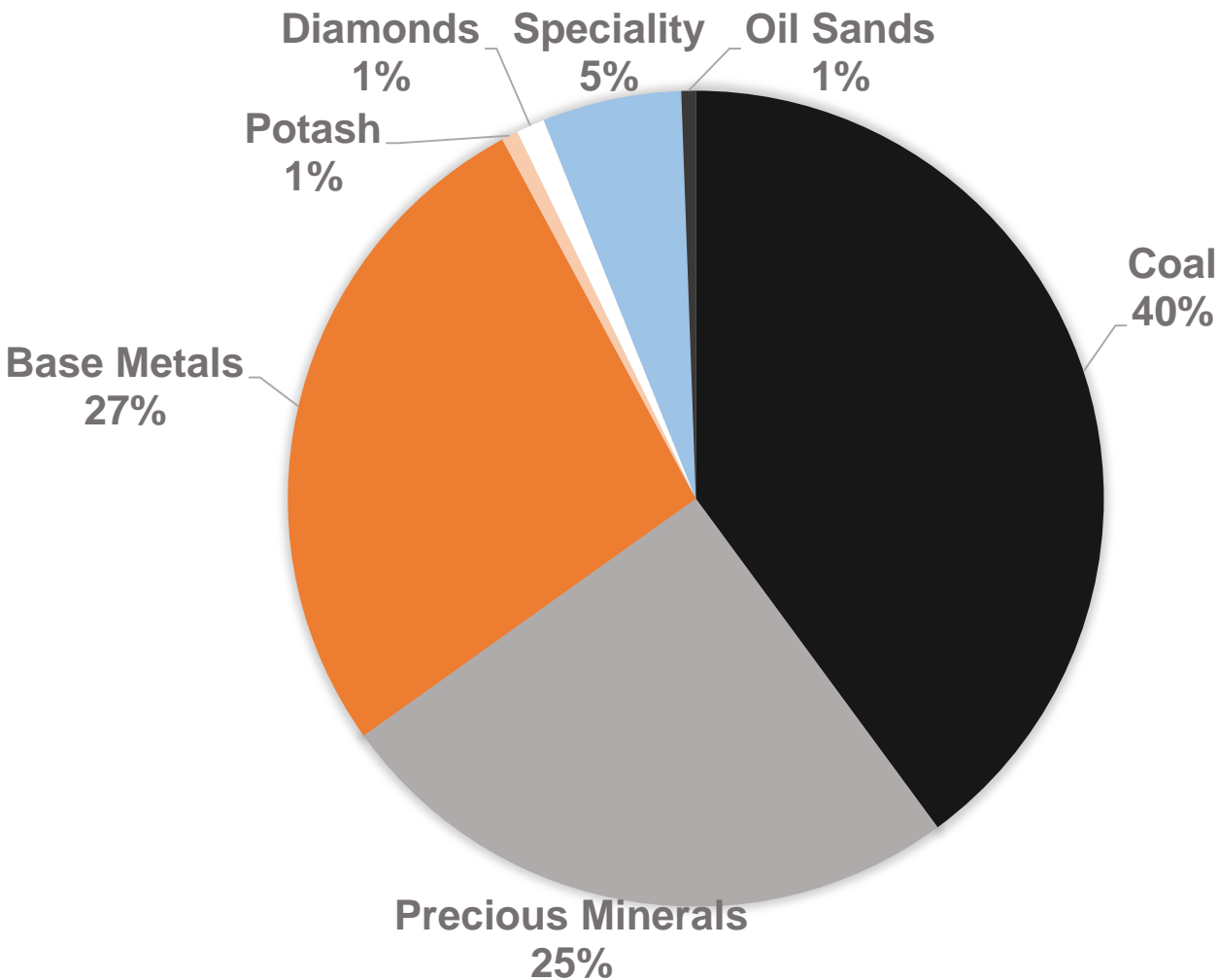

MARKET OPPORTUNITY - SCHEDULING

For personal use only

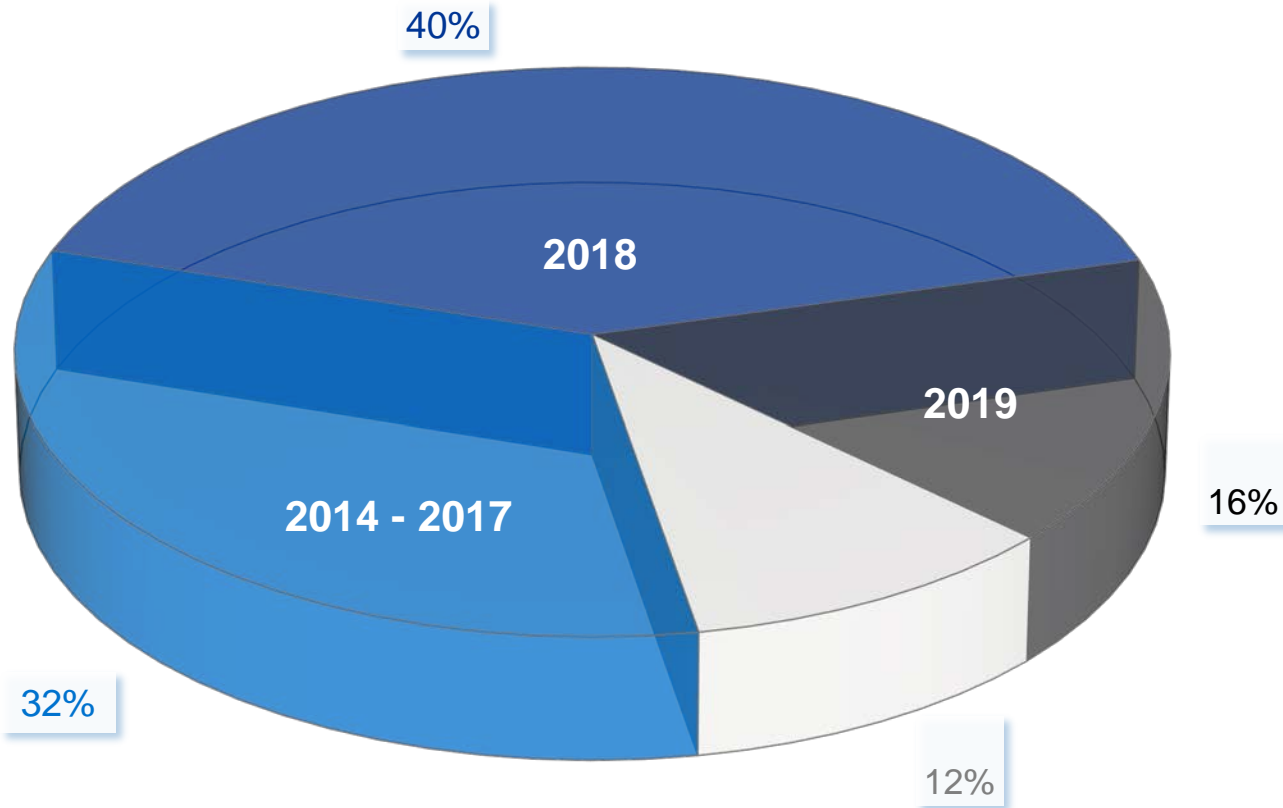

YEAR REVENUE BEGINS

- FY2014 – OPEN PIT METALS (24%)**
- FY2015 – OIL SANDS (1%)**
- FY2016 – OPEN PIT DIAMONDS (1%)**
- FY2017 – STRATIGRAPHIC METALS (5%)**
- FY2018 – OPEN CUT COAL (21%)**
- FY2018 – UNDERGROUND METALS (19%)**
- FY2019 – STEEPLY DIPPING COAL (8%)**
- FY2019 – UNDERGROUND COAL (8%)**

OUTLOOK

- We are currently in the process of implementing five new software products (Open Cut Coal, SIMULATE, Open Cut Phosphate, XECUTE and Underground Metals) for the very first time. We firmly believe that having reference sites for each of these products will accelerate their market acceptance.
- The Company expects demand for its Advisory services to rise in the coming year as mining companies begin investigating new projects with a view to growing or replacing their depleted resources and reserves.
- The signs of coal exploration recovery in Australia are strong which should see our gas testing laboratories remaining busy during FY18.
- The last 12 months have seen the Company invest \$12.8 million in internal software development, fully integrate the iSolutions business, acquire the intellectual property rights to a Short Internal Control system, sign software Integration Agreements with the industry's leading Stope Optimisation and Ventilation vendors as well as announce the acquisition of the industry's leading provider of Equipment Access Layout software for underground mines. All of which provide the Company with a more complete and richer set of software products than it had twelve months ago.

DISCLAIMER

The material in this presentation is a summary of the results of RPMGlobal Holdings Limited (RPM) for the full year ending 30 June 2017 including historical financial information from the prior financial year's results as announced to the market and an update on RPM's business and activities and is current at the date of preparation, 28 August 2017. Events (including changes to any of the data and information that RPM used in preparing this presentation) may have occurred since that date which may impact on the information contained in this presentation and make them unreliable. RPM is under no duty to update this presentation though it reserves the right to do so. Further details are provided in RPM's Appendix 4E and Annual Report for the full year ended 30 June 2017 released on 28 August 2017.

This presentation provides information in summary form only and is not intended to be complete. It is not intended to be relied upon as advice to investors or potential investors and does not take into account the investment objectives, financial situation or needs of any particular investor.

No representation, express or implied, is made as to the fairness, accuracy, completeness or correctness of information contained in this presentation, including the accuracy, likelihood of achievement or reasonableness of any forecasts, prospects, returns or statements in relation to future matters contained in the presentation ("forward-looking statements"). Such forward-looking statements are by their nature subject to significant uncertainties and contingencies and are based on a number of estimates and assumptions that are subject to change (and in many cases are outside the control of RPM and its Directors and Officers) which may cause the actual results or performance of RPM to be materially different from any future results or performance expressed or implied by such forward-looking statements.

Due care and consideration should be undertaken when considering and analysing RPM's financial performance. All references to dollars are to Australian Dollars unless otherwise stated.

To the maximum extent permitted by law, neither RPM nor its related corporations, Directors, Officers, employees or agents, nor any other person, accepts any liability, including, without limitation, any liability arising from fault or negligence, for any loss arising from the use of this presentation or its contents or otherwise arising in connection with it. This presentation should be read in conjunction with other publicly available material including but not limited to RPM's Appendix 4E and Annual Report for the full year ended 30 June 2017 released on 28 August 2017. Further information including historical results and a description of the activities of RPM is available on our website, www.rpmglobal.com.

RPMGlobal and the RPM software products and services referenced in this presentation are the registered and unregistered trademarks of RPMGlobal Holdings Limited. The material in this presentation is the copyright of RPMGlobal Holdings Limited and may not be re-used in whole or in part without the prior consent of RPM.